



Main Entrance (Room 120)

- Circulation and Reference Desk
- ILL and document delivery
- LOUIS cards
- Scanner and color printer

Standing & Sitting Computer Stations (Room 120)

- 12 standing & 7 sitting computers
- First come, first served
- Printing available for students only

Open Computer Lab (Room 121)

- 40 computers
- First come, first served
- No time limit
- MagicMagnifier, AutoCAD, and Hawkes software on selected computers
- Printing unavailable

Library Classroom (Room 123)

- 24 computers
- Wipe-off erase board
- Instructor's podium equipped with computer, DVD and VHS players, and document display connected to LCD projector

Conference Room (Room 124)

- Group study
- Wipe-off erase board
- Please check at Circulation Desk for availability

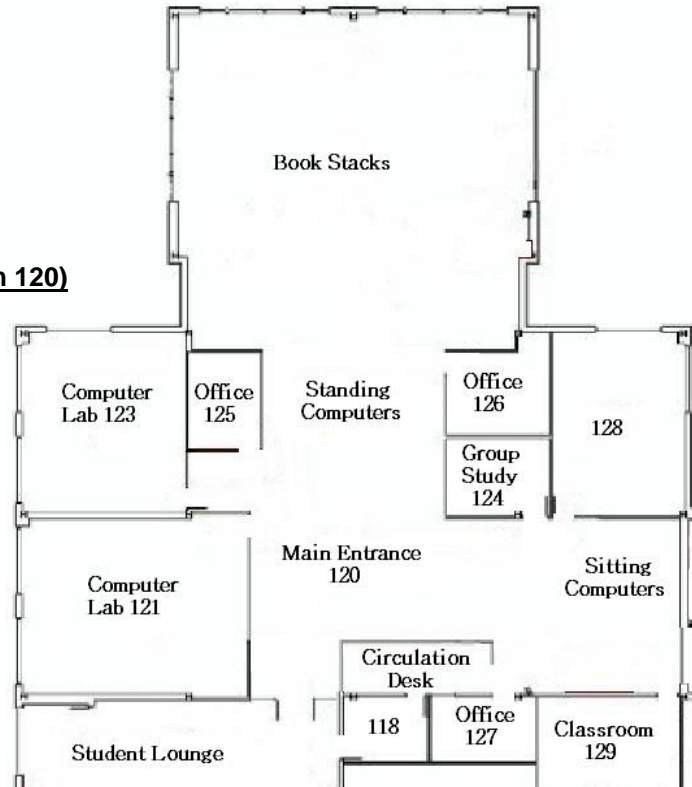

Staff Directory

Katherine Rolfes Director	Room 125 521-8906	katherine.rolfes@solacc.edu
Jennifer Gauthier Schmidt Access Services Librarian	Room 127 521-8935	jennifer.gauthier@solacc.edu
Bill French Access Services Librarian	Room 127 521-8998	bill.french@solacc.edu
Lawren Dodson Library Specialist	Room 126 521-1740	lawren.dodson@solacc.edu