

SYDNEY ROAD

SECTIONS 17 AND 18, TOWNSHIP 28E, RANGE 21E

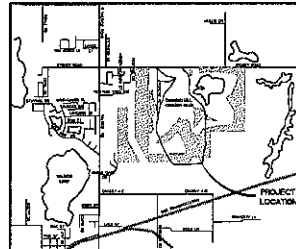

- TRACTS CONVEYED TO THE DIAMOND HILL COMMUNITY DEVELOPMENT DISTRICT
- TRACTS CONVEYED TO THE DIAMOND HILL MASTER HOMEOWNER ASSOCIATION, INC.
- TRACTS DEDICATED TO HILLSBOROUGH COUNTY

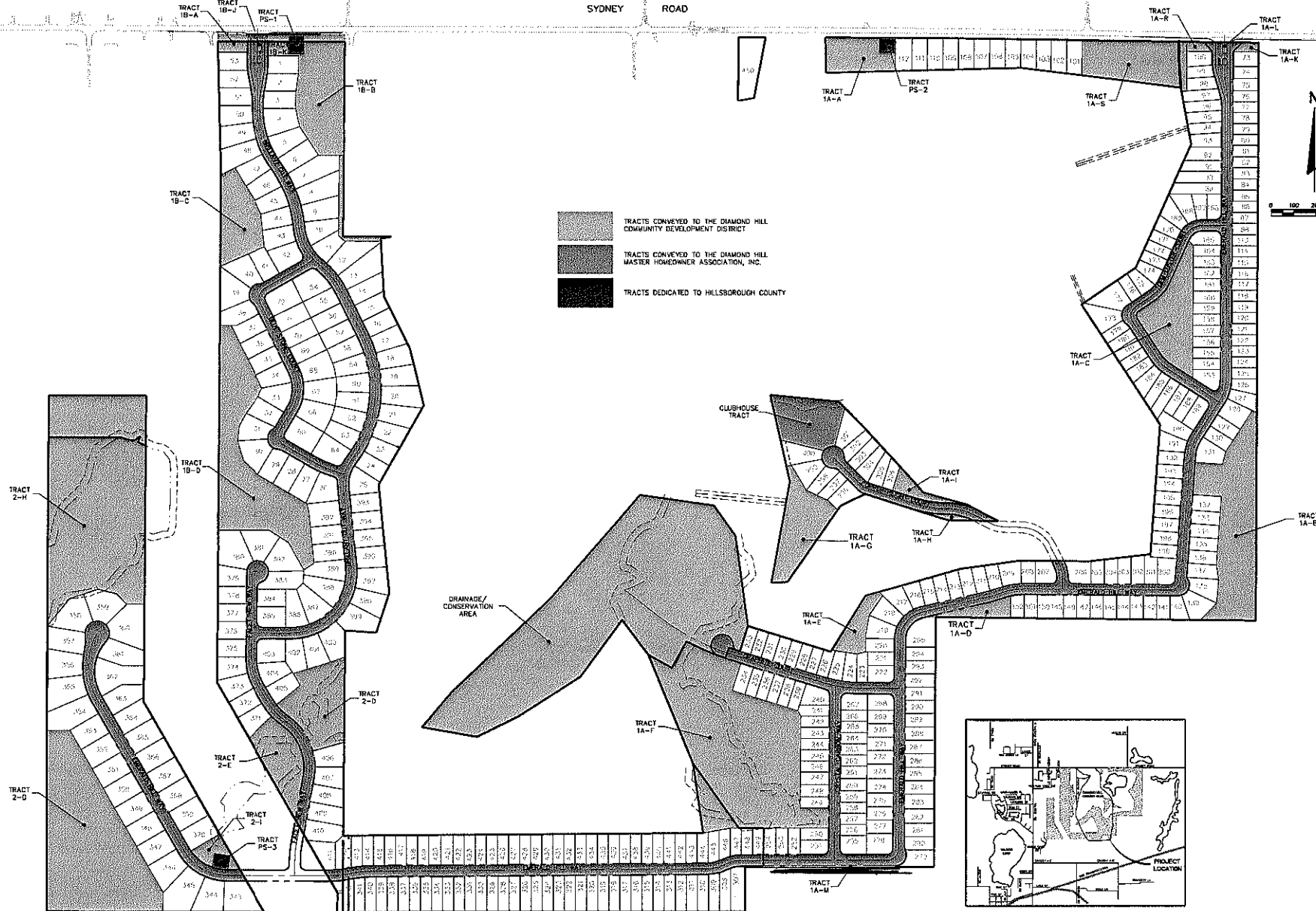

DESIGNED BY	SC
CHECKED BY	JMS
DATE	SC
BY	EM

FLORIDA DESIGN CONSULTANTS, INC.
 ENGINEERS, ENVIRONMENTALISTS, SURVEYORS & PLANNERS
 3000 Sydney Blvd., New Port Richey, FL 34050
 Tel: (727) 845-1500 Fax: (727) 848-3010

PREFARED FOR:
RYLAND HOMES
 255 PINE AVE. N.
 OLDSMAR, FL 34677
 MAIN PHONE: (813) 329-7600 FAX: 813-329-7689

SHEET DESCRIPTION:
**DIAMOND HILL SUBDIVISION
 DEDICATION PLAN**

DATE	10/05/04
BY	EM
SCALE	AS SHOWN
PROJECT NO.	02E-30
SHEET NO.	43
TOTAL SHEETS	47

© Copyright 2004 Florida Design Consultants, Inc. Drawings and contents may not be used or reproduced without written permission.