

# Templeton USD Bond Study Session

March 24, 2026

TEMPLETON UNIFIED SCHOOL DISTRICT



## OUR VALUES

INTEGRITY  
EMPATHY  
INNOVATION  
COLLABORATION  
GROWTH MINDSET

TEMPLETON UNIFIED SCHOOL DISTRICT



## OUR VISION

WE PREPARE STUDENTS TO BECOME LIFELONG  
LEARNERS AND IMPACTFUL INDIVIDUALS;  
UPLIFTING OUR COMMUNITY IN AN  
EVER-CHANGING WORLD.

TEMPLETON UNIFIED SCHOOL DISTRICT



## OUR MISSION

TUSD EMPOWERS STUDENTS BY BUILDING  
RELATIONSHIPS, CREATING A SUPPORTIVE  
ENVIRONMENT, AND PROVIDING  
STUDENT-CENTERED, EDUCATIONAL  
EXPERIENCES FOR ALL.

# Agenda

- Review exchange of Templeton Middle School and Vineyard Elementary School.
  - Vineyard Campus would house grades 6<sup>th</sup>, 7<sup>th</sup>, and 8<sup>th</sup> grades.
  - Templeton Elementary Campus (and old middle school) would house grades Pre-K through 5<sup>th</sup> grades.
- Review proposals for architectural and engineering services from Mark Finney, Finney Architects.
  - Vineyard Campus – 10 classroom building complex (H-wing).
  - Templeton Elementary Campus PK/TK/K 8 classroom building complex (K-wing).

# School Site Exchange

To move or not to move....

## Yes - Vineyard into Middle School - Proposed Site Plan

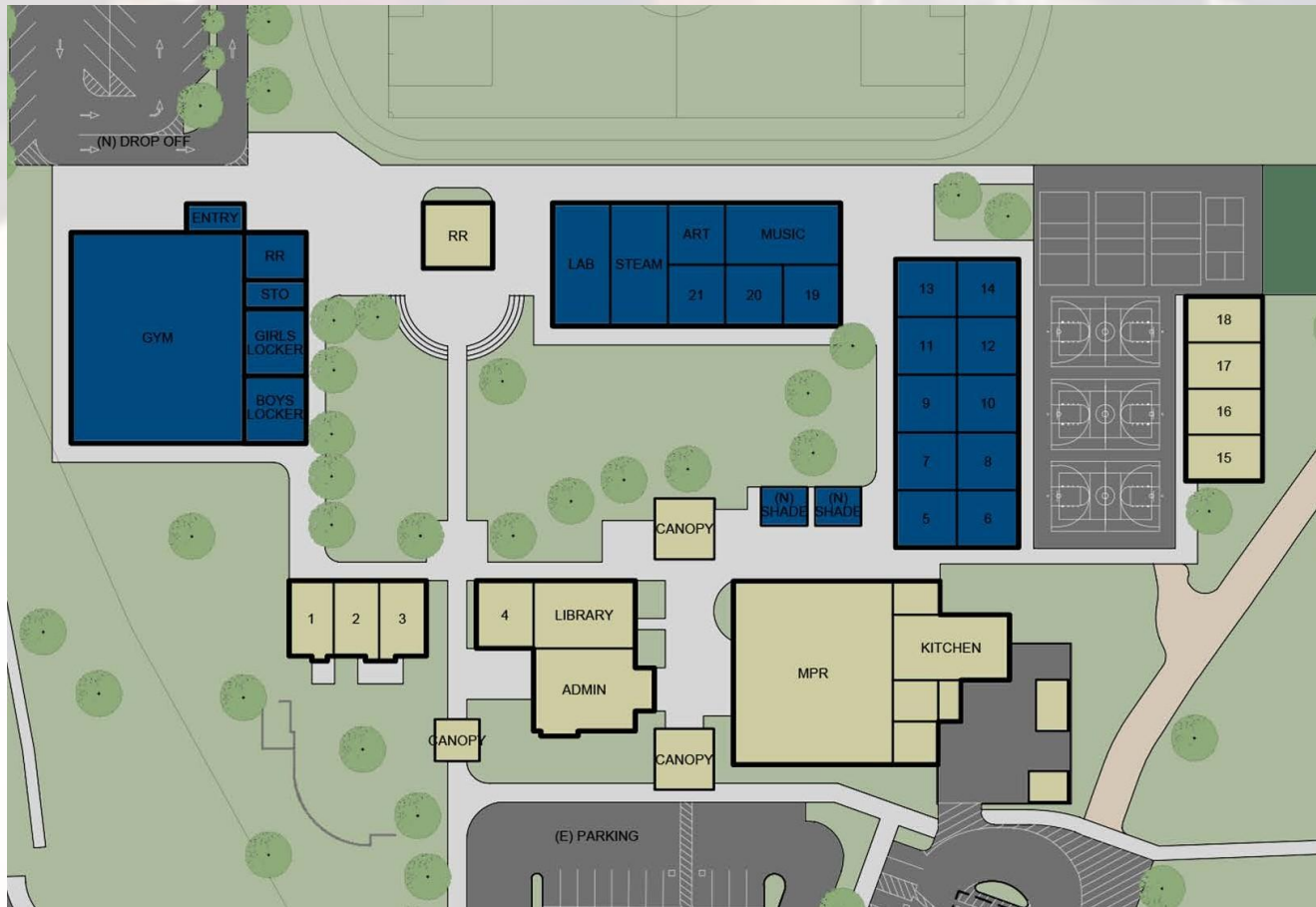

# School Site Exchange

To move or not to move....

## Yes - Templeton Elementary Grades PK - 5th Grade Proposed Site Plan

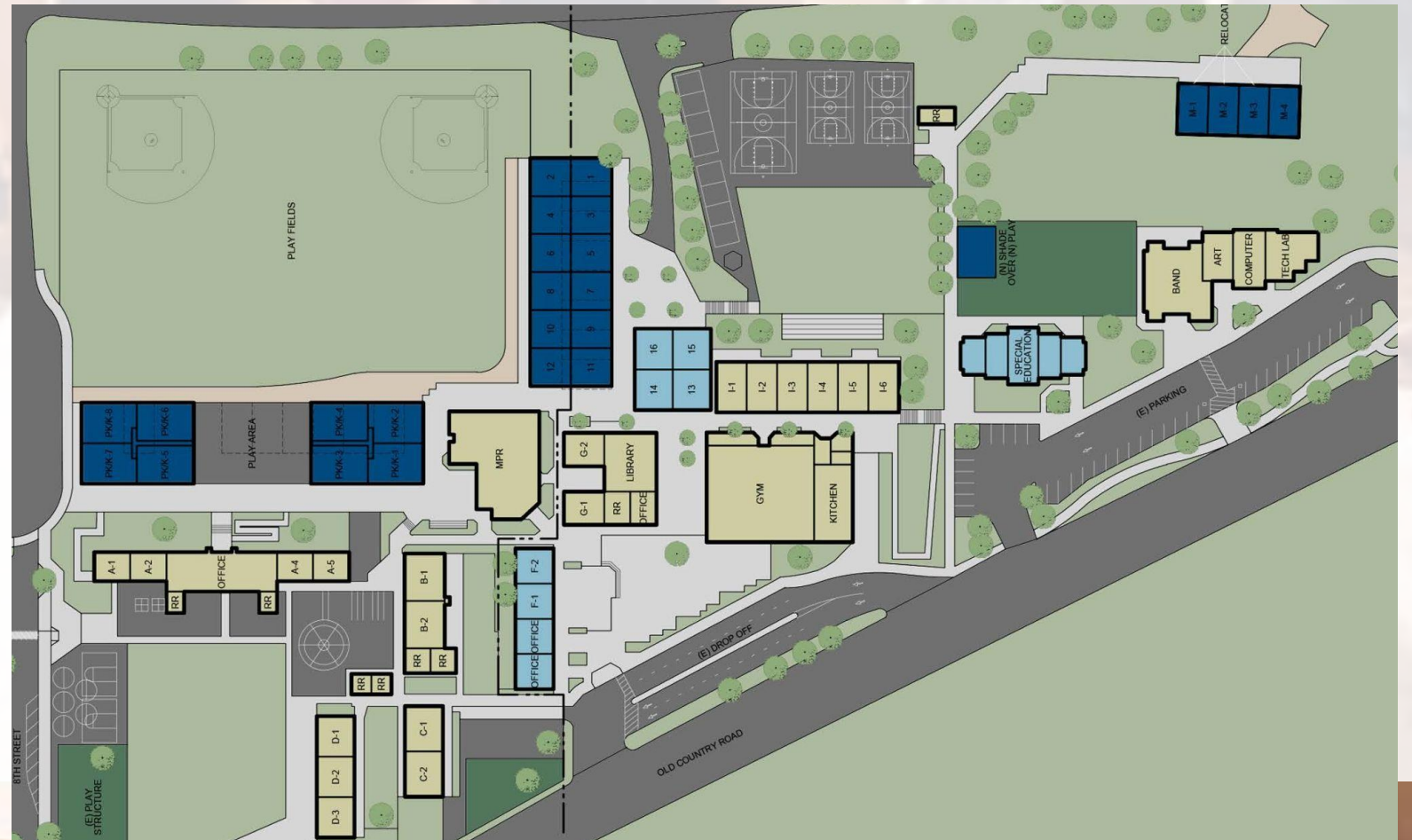

# School Site Exchange

To move or  
not to move....

## Other Facility Improvements - Current Unfunded List

- Shade structures TES playground and outdoor tables
- Shade structure for the VES outdoor tables
- Shade structure for the TMS outdoor
- Shade structure for the THS quad
- Full size track at Vineyard
- Lighting at tennis courts
- Additional PAC parking

# School Site Exchange

To move or  
not to move....

Cost Estimates based on current proposed costs for campus exchange and proposed costs for status quo.

Cost Estimate

# School Site Exchange

To move or  
not to move....

Cost comparison estimate of campus exchange option and status quo.

- VES as Middle School Grades 6th through 8th - \$28,742,386
- TES Grades PK through 5th - \$21,805,392
- Other Projects - \$9,993,225

**Total Projects Estimated - \$60,541,003**

- VES to remain status quo - \$15,241,016
- TES to remain status quo - \$22,301,962
- Other Projects - \$12,715,875

**Total Projects Estimated - \$50,258,853**

# Measure D Bond \$52.3 million

## Series A Issuance

- May 2025
- Issuance with fees - \$25,342,559.30
  - **Cash Received - \$23,731,394.21 (93%)**

Potential Issuance Schedule*		
Year	Term	Amount
2025	25 Years	\$24,300,000
2028	25 Years	\$14,700,000
2031	25 Years	\$13,300,000
<b>Total</b>		<b>\$52,300,000</b>

\* Assumes 3.5% annual assessed value growth. 4.50% average interest rate.

## State Matching Funds

### Modernization Eligibility Campus Exchange

- Vineyard into Middle School - \$3,235,310
- Templeton Elem. (Grades PK-5) - \$73,869
- **Total - \$3,309,179**

### Modernization Eligibility Status Quo

- Vineyard to stay Elementary - \$3,295,264
- Templeton Middle School stays - \$1,270,239
- **Total - \$4,565,503**

### New Construction

District Wide (No impact if exchange takes place)

- **\$6,156,260**

**Total state dollars with move  
\$9,465,439**

**Total state dollars without move  
\$10,721,763**

**(\$1,256,324)**

## Total Facility Funds

- Measure D Funds (after fees 93%) - \$48,973,720
- Total state dollars with exchange - \$9,465,439
- District Funds - \$8,536,793

○ Total Funds - \$66,975,952

- Measure D Funds (after fees 93%) - \$48,973,720
- Total state dollars status quo - \$10,721,763
- District Funds - \$8,536,793

○ Total Funds - \$68,232,276

# Questions?

TEMPLETON UNIFIED SCHOOL DISTRICT



## OUR VALUES

INTEGRITY  
EMPATHY  
INNOVATION  
COLLABORATION  
GROWTH MINDSET

TEMPLETON UNIFIED SCHOOL DISTRICT



## OUR VISION

WE PREPARE STUDENTS TO BECOME LIFELONG  
LEARNERS AND IMPACTFUL INDIVIDUALS,  
UPLIFTING OUR COMMUNITY IN AN  
EVER-CHANGING WORLD.

TEMPLETON UNIFIED SCHOOL DISTRICT



## OUR MISSION

TUSD EMPOWERS STUDENTS BY BUILDING  
RELATIONSHIPS, CREATING A SUPPORTIVE  
ENVIRONMENT, AND PROVIDING  
STUDENT-CENTERED, EDUCATIONAL  
EXPERIENCES FOR ALL.

Planning the  
Process -  
Finney  
Architectural  
and  
Engineering  
Services



**TES / TMS**



**DESIGN / BID**



**BUILD**

# Planning the Process - Finney Architectural and Engineering Services

Vineyard Campus – 10 classroom building complex (H-wing).

Provide architectural design, mechanical and plumbing engineering, structural engineering, civil engineering, electrical and low voltage engineering and landscape engineering as needed to complete a new single-story wood framed double loaded ten classroom building complex, with classrooms at 960 square feet. There are no support spaces nor bathrooms included in this classroom complex. Our design will include demolition of 5 existing portable classrooms, the new classroom complex, miscellaneous pavement and landscaping and likely a full fire alarm installation for the campus.

- Estimated Cost for Demolition of 5 Portables:  $(5 \times 960) \times \$15 = \$72,000$
- Ten new Classrooms:  $(10 \times 960) \times \$425 = \$4,080,000$
- Miscellaneous Landscaping and Pavement: 33% of \$500,000 = \$165,000
- Fire Alarm Upgrade: \$500,000

**Total Estimate Construction cost: \$4,817,000**

**We propose a fixed fee of 8% of the estimate cost which is a fixed fee (no matter the actual bid amount): \$385,360.**

# Planning the Process - Finney Architectural and Engineering Services

Templeton Elementary Campus PK/TK/K 8 classroom building complex (K-wing).

Provide architectural design, mechanical and plumbing engineering, structural engineering, civil engineering, electrical and low voltage engineering and landscape engineering as needed to complete a new single-story wood framed double loaded eight 1350 sq. ft classroom building complex. It is our understanding that there will be several interior bathrooms associated with the PK through Kindergarten classrooms. The scope of work includes a paved play area, a play structure with fall matting, miscellaneous pavement and landscaping, relocation and removal of several portable classrooms and likely a full fire alarm installation for the campus.

- Estimated Cost for Demolition of 5 Portables:  $(6 \times 960) \times \$15 = \$86,400$
- New Classrooms:  $11200 \times \$425 = \$4,760,000$
- Miscellaneous Landscaping and Pavement: 33% of \$1,000,000 = \$333,333
- Fire Alarm Upgrade: \$500,000
- Relocation of Portable and stored only safe off: \$10,000
- Alteration to the Grass Field or track: \$25,000
- Play Area: \$255,000 / Play Structure and Fall Protection: \$225,000

**Total Estimate Construction cost: \$6,194,333**

**We propose a fixed fee of 8% of the estimate cost which is a fixed fee (no matter the actual bid amount): \$495,546.**

# Questions / Thank you

TEMPLETON UNIFIED SCHOOL DISTRICT



## OUR VALUES

INTEGRITY  
EMPATHY  
INNOVATION  
COLLABORATION  
GROWTH MINDSET

TEMPLETON UNIFIED SCHOOL DISTRICT



## OUR VISION

WE PREPARE STUDENTS TO BECOME LIFELONG  
LEARNERS AND IMPACTFUL INDIVIDUALS;  
UPLIFTING OUR COMMUNITY IN AN  
EVER-CHANGING WORLD.

TEMPLETON UNIFIED SCHOOL DISTRICT



## OUR MISSION

TUSD EMPOWERS STUDENTS BY BUILDING  
RELATIONSHIPS, CREATING A SUPPORTIVE  
ENVIRONMENT, AND PROVIDING  
STUDENT-CENTERED, EDUCATIONAL  
EXPERIENCES FOR ALL.