



# Brunswick ES Feasibility Study

PTO Meeting Update 9/11/19

# Purpose

- Investigate existing BES building to determine best way to modernize and provide additional capacity
- Consider several scenarios
  - Renovate the current building
  - Renovate the current building and build an addition
  - Replace the building
- Scenarios are conceptual in nature and further consideration of site layout and school design will be completed at the time of design

# Process

- Accelerated time frame so that information about the existing building can be used to inform our funding request for FY21
- Consultant hired to perform study
- Schedule:
  - August 2019: Proffitt & Associates Architects hired
  - August 2019: Investigate existing building and site conditions
  - August - September 2019: Analyze various ways to provide additional capacity and modernize the building
  - September 2019 - October 2019: Prepare feasibility study report including cost estimates
  - October 30, 2019: Board of Education presentation

# Educational Facilities Master Plan July 2019

## Proposed Timeline for Major Projects, 2019 - 2028

### KEY

	Feasibility	Design	Construction
Elementary			
Middle			
High			
Other			

### CONSTRUCTION SCHEDULE

School Year	2019-2020*	2020-2021	2021-2022	2022-2023	2023-2024	2024-2025	2025-2026	2026-2027	2027-2028	2028-2029
Fiscal Year	2020*	2021	2022	2023	2024	2025	2026	2027	2028	2029
Urbana ES Replacement		Open								
Rock Creek Replacement			Open							
East County area ES			Open							
Oakdale MS Addition			Open							
Waverley ES Replacement		Potential Redistricting		Open						
Brunswick ES Modernization										
Brunswick Area ES					Open					
Liberty ES Replacement			Potential Redistricting		Open					
Northern Frederick Area ES						Redistricting		Open		
Valley ES Modernization/ Addition						Potential Redistricting		Open		
Brunswick HS Modernization and Addition								Open		
Middletown MS Modernization									Open	
Walkersville MS Modernization										Open
Middletown HS Modernization										Open
South Frederick Area ES									Redistricting	
Yellow Springs ES Modernization										
Green Valley Modernization										
Monocacy ES Modernization										
Middletown ES Modernization										
Limited Renovations (Locations TBD)										

<https://www.fcps.org/capital-program/efmp>

# Existing Building Survey Preliminary Findings

- Building constructed in 1952 with additions and renovations in 1958, 1978 and 1980

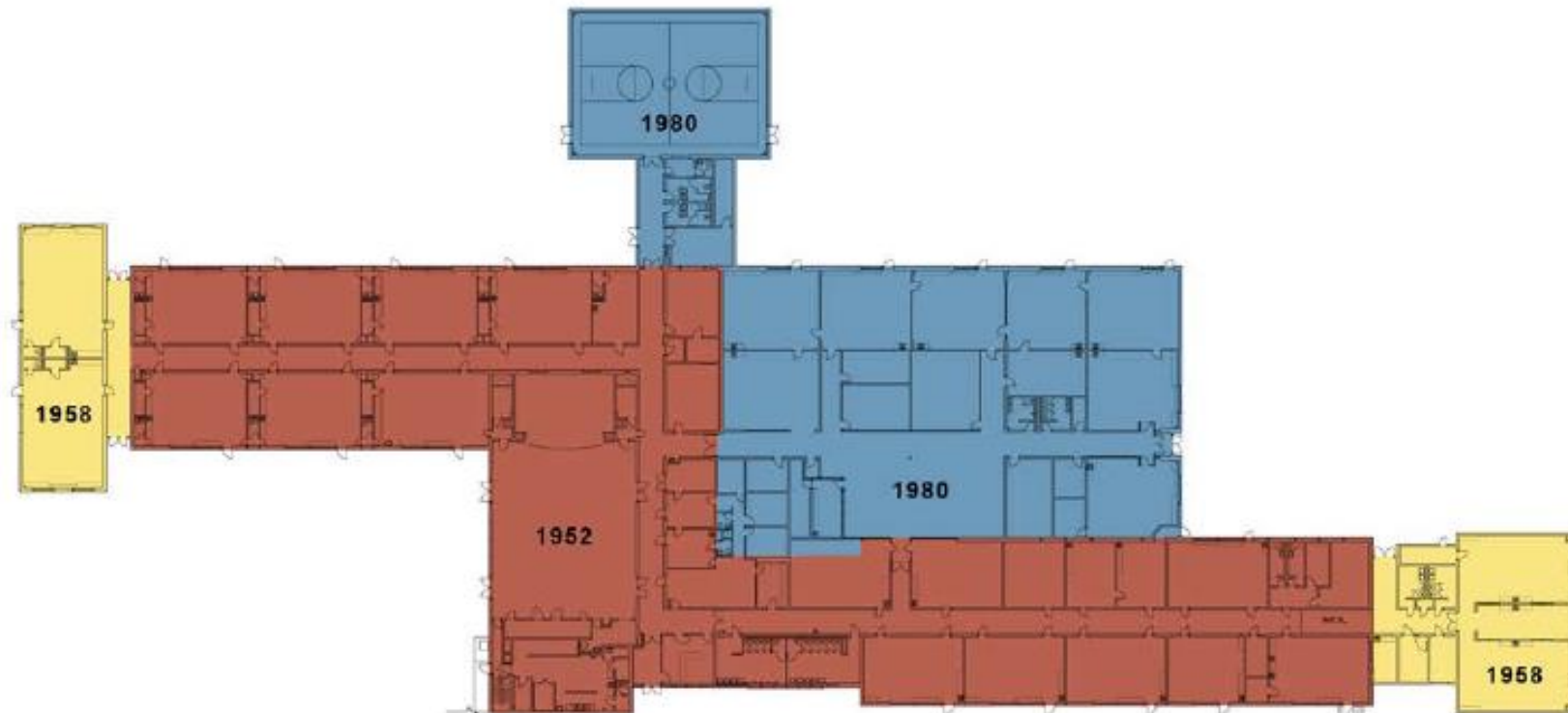

# Existing Building Survey Preliminary Findings

- Building envelope needs some improvements to meet current energy codes



Many areas require repointing below windows

# Existing Building Survey Preliminary Findings

- Roof is 12-20 years old



Overview of built-up asphalt roof at original construction south wing

# Existing Building Survey Preliminary Findings

- Accessibility issues need to be addressed



Drinking fountain is not an accessible high-low type



Single-user toilet rooms are not ADA compliant due to size and door width

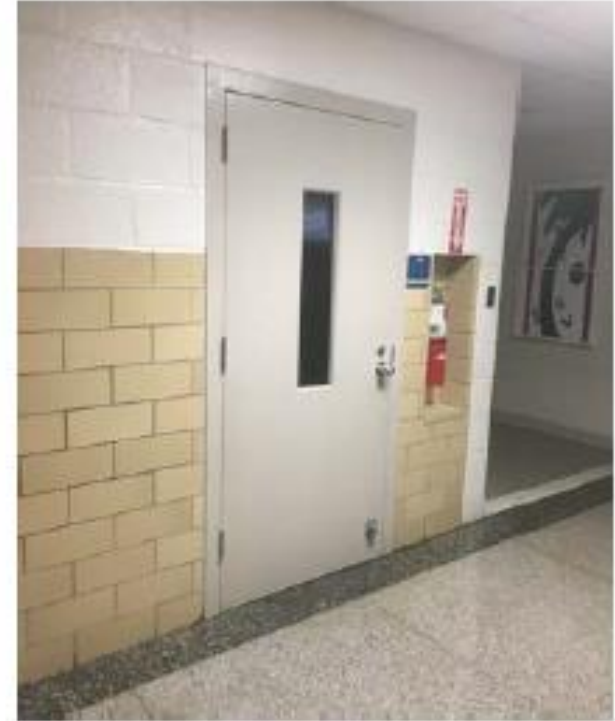

Nearly all of the existing door hardware is non-ADA compliant



# Existing Building Survey Preliminary Findings

- Classroom unit ventilators were replaced in 2000, Oil boilers and rooftop units were replaced in 2005



Main mechanical room boilers



Main mechanical room pumps

# Next Steps

- Consultant team preparing feasibility study
- Cost estimates will be prepared for each scenario
- Feasibility study is scheduled to be presented at the October 30 BOE meeting. Feasibility study report will be posted on the BOE agenda website (BoardDocs) the week before the meeting