

REGISTER as a CANVAS PARENT OBSERVER

1. Through your **student's** Canvas account, access a pairing code by selecting **Account**, then **Settings**.
2. Select "**Pair with Observer**" from the sidebar on the right of the settings page.
3. Copy or write down the "**Pairing Code**".

Step 1

Step 2

Step 3

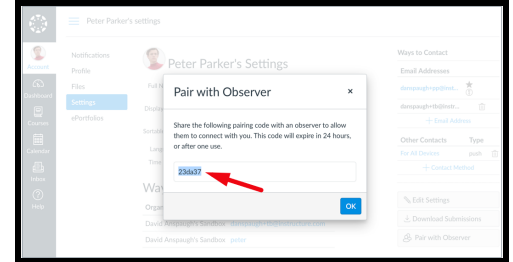
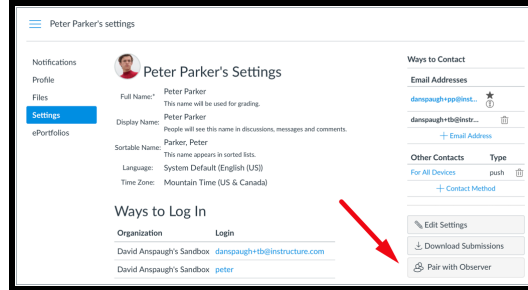
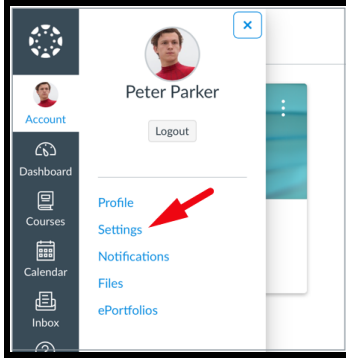

4. On a separate device, use this URL to access Canvas: <https://op97.instructure.com/> (Please bookmark this specific URL to use going forward.)
5. Click on the Parent of a User link option..

A screenshot of the Canvas login page for a parent of a user. The page features the logos for 'WIND DISTRICT 02' and 'IB'. The text reads 'Parent of a Canvas User? Click Here For an Account'. There are input fields for 'Username' and 'Password', a 'Log In' button, and a 'Forgot Password?' link. A large black arrow points from the right towards the page.

6. Enter Your Name, the email you'd like to use as your username, and your preferred password.
7. Enter the "**Student Pairing Code**" you received from inside your student's account.
8. **Agree to the Terms and Start Participating!**

To add another student:

1. Log into Canvas as an Observer.
2. Through your **Account, Settings**, select "**Observing**"
3. Add a student by using the blue **+ Student** button.
4. Enter the additional student's "Pairing Code" (steps 1-2-3 from above).